

WATER GATE OPENING INDICATOR

Shaft-Rotation Type (NTX210 Series)

- Direct input of shaft rotation of gate hoist
- Water-resistant structure (up to 10m depth)
- Available synchro transmitter (type 86G)
- Selectable reduction gear ratio (6/1~1/10)



Summary

- NTX210 Series is a gate opening indicator by directly measuring a shaft rotation of the water gate hoist.
- Also available for submersible Derricking gate because of water-resistant structure (up to 10m depth)
- Synchro transmitter can be mounted for output signal.

Main specification

Ambient Temperature	-10°C to +50°C
Ambient Humidity	30 to 90% RH (Non condensing)
Structure of Main Body	Rainproof (up to 10m depth)
Indicator accuracy	±0.5%F.S
Allowable rotation speed	10r/min.
Allowable radial load	49N(5kg·f)
Allowable thrust load	29.4N(3kg·f)
Shaft friction torque	1.47N·m(15kg·f·cm)
Gear ratio	6/1 to 1/10
Weight	Approx. 20kg

Model name: NTX210-86S[A]

Code	Option Type	Option Detail Number
[A]	Externals shape (side viewed from the side of the input shaft)	A : Conduit position : Right There is a cable connection. B : Conduit position : Left There is a cable connection. C : Conduit position : Right There is a cable no connection. D : Conduit position : Left There is a cable no connection.

System configuration

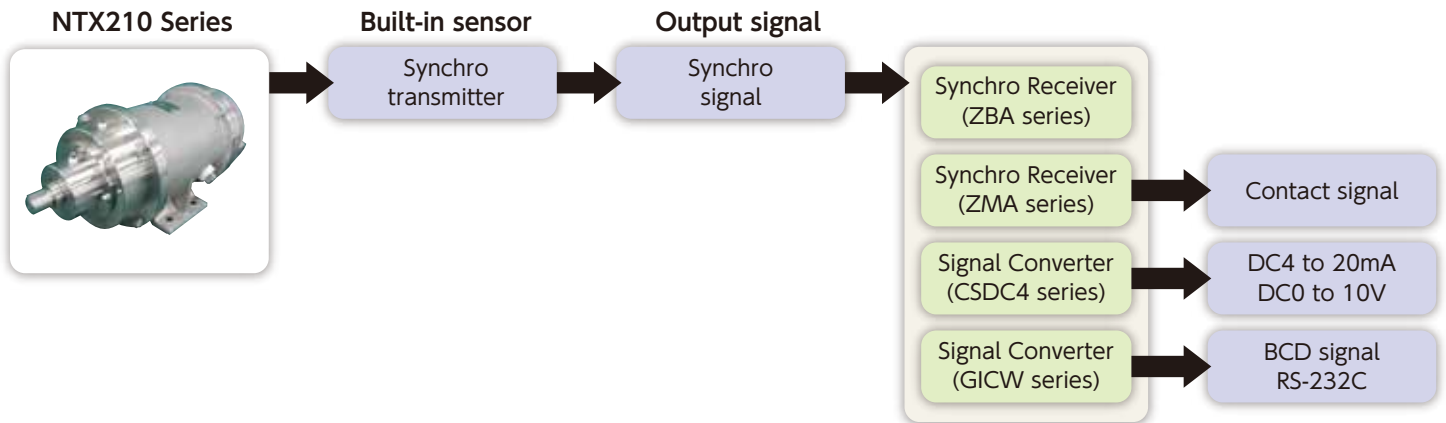

Outline drawing

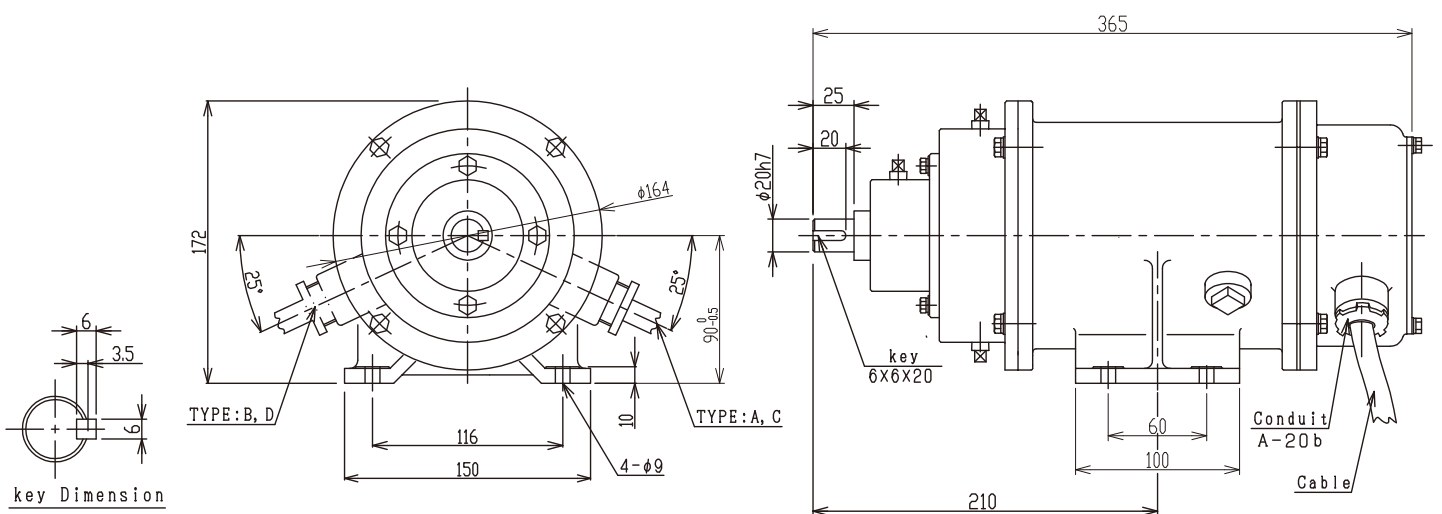

※Information in this document is subject to change without notice